

# LTN8816 / LTN8832

## Embedded NVR

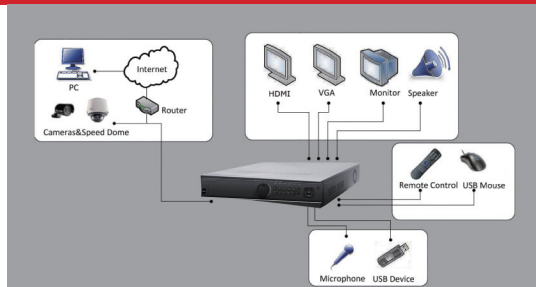

### Key features

- Third-party network cameras supported
- Up to 6 Megapixels resolution recording
- HDMI and VGA output at up to 1920×1080P resolution
- 4 SATA interfaces, up to 6TB for each disk
- Support NAS, IP SAN Network Storage
- 4 x POS(LTN8816), 8 x POS(LTN8832)
- HDD quota and group management
- Gigabit network interfaces

### Rear Panel of LTN8816, LTN8832

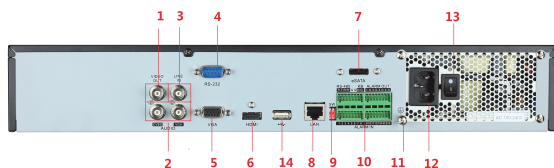

1. Video out
2. CVBS Audio out and VGA audio out
3. Line in
4. RS-232 interface
5. VGA interface
6. HDMI interface
7. eSATA interface
8. LAN interface
9. Termination switch
10. RS-485 interface, Controller port, Alarm in and Alarm out
11. Ground
12. AC 100V ~ 240V
13. Power
14. USB interface

	LTN8816	LTN8832
<b>Video/Audio input</b>		
IP video input	16-ch	32-ch
Two-way audio input	1-ch, BNC (2.0 Vp-p, 1kΩ)	
Incoming bandwidth	100Mbps	200Mbps
<b>Video/Audio output</b>		
Recording resolution	6MP/5MP/3MP/1080P/UXGA/720P/VGA/4CIF/DCIF/2CIF/CIF/QCIF	
CVBS output	1-ch, BNC (1.0 Vp-p, 75 Ω) Resolution: 704 × 576 (PAL); 704 × 480 (NTSC)	
HDMI output	1-ch, resolution: 1920 × 1080P /60Hz, 1600 × 1200 /60Hz, 1280 × 1024 /60Hz, 1280 × 720 /60Hz, 1024 × 768 /60Hz	
VGA output	1-ch, resolution: 1920 × 1080P /60Hz, 1600 × 1200 /60Hz, 1280 × 1024 /60Hz, 1280 × 720 /60Hz, 1024 × 768 /60Hz	
Audio output	2-ch, BNC (Linear, 600Ω)	
Playback resolution	6MP/5MP/3MP/1080P/UXGA/720P/VGA/4CIF/DCIF/2CIF/CIF/QCIF	
Synchronous playback	16-ch	
<b>Hard disk</b>		
SATA	4 SATA interfaces for 2 HDDs + 1 DVD-R/W (default), or 4HDDs	
eSATA	1 eSATA interface	
Capacity	Up to 6TB capacity for each HDD	
<b>External interface</b>		
Network interface	1 RJ-45 10 / 100 / 1000 Mbps self-adaptive Ethernet interface	
Serial interface	1 RS-232 interface (for parameters configuration, maintenance, transparent channel); 1 RS-485 interface (reserved); 1 RS-485 keyboard interface (for special keyboard control)	
USB interface	3 × USB 2.0	
Alarm in	16	
Alarm out	4	
<b>General</b>		
Power supply	100 ~ 240VAC, 6.3A, 50 ~ 60Hz	
Consumption	≤ 35 W	≤ 40 W
Working temperature	-10 °C ~ +55 °C(14 ° F ~ 131 ° F)	
Working humidity	10% ~ 90%	
Chassis	19-inch rack-mounted 1.5U chassis	
Dimensions(W×D×H)	440 × 390 × 70mm(17.3" x 15.3" x 2.8")	
Weight	≤ 4 Kg (8.82 lb) ( without hard disk or DVD-R/W )	